

NEXGEN

BUILDING PRODUCTS

NEXGEN MAXTERRA™ MgO SUBFLOORING FOR FIRE RESISTANCE SOUND ABSORPTION AND LONG LIFE

WHY MgO IS AN IDEAL SOLUTION

NEXGEN MAXTERRA™ MgO high density structurally rated magnesium oxide panels can be used as a direct replacement for plywood and OSB for subflooring panels. NEXGEN panels can be easily attached directly to wood or steel joists using corrosion-resistant screws.

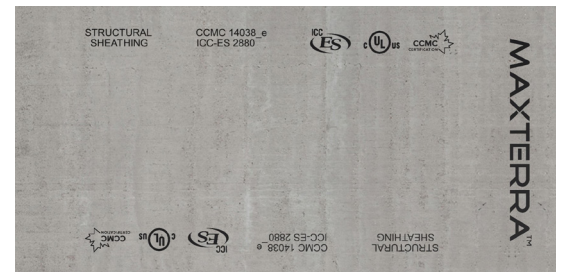

BENEFITS OF MAXTERRA SUBFLOORING

Fire Resistance

All the NEXGEN MgO disaster resistant attributes increase life safety and protect your investment. MAXTERRA panels are non-combustible, and have zero flame and no smoke spread.

Easy Installation

NEXGEN MgO uses traditional construction methods including sawing, scoring & break, and screws. Fast installation with less steps using a single trade for floor subflooring applications.

Water Resistance

Using a building product that is water resistant has never made more sense. NEXGEN MgO products do not rapidly deteriorate when immersed in water over a short period and can maintain structural stability.

Eco-Friendly

NEXGEN MAXTERRA is made using environmentally conscious materials and is non-toxic, no VOCs, no off-gassing. The manufacturing process is carbon negative and end of life disposal has low environmental impact.

THE BEST TEST RESULTS AND CERTIFICATIONS



1-Hour Fire Rated Wood

1-Hour Fire Rated Steel Sides

2-Hour Fire Rated Steel

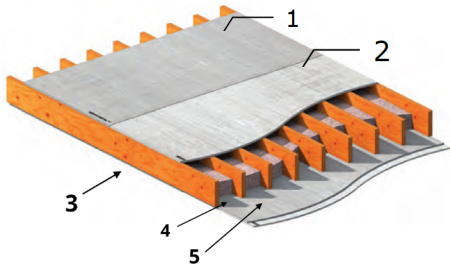

Wood Assembly

1. Flooring Material
2. 3/4" NEXGEN MgO Panel
3. 1 3/4"x9 1/2" LVL Floor Joists @ 12" OC.
4. 5.5" Roxul Comfort Plus
5. 1/2" NEXGEN MgO or 5/8" gypsum

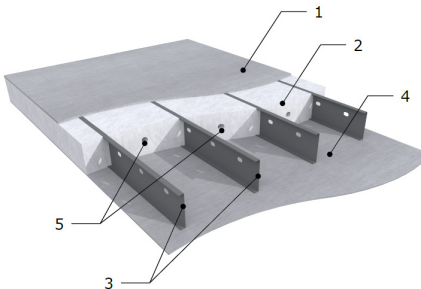

B-017 Assembly

1. 3/4" NEXGEN MgO Panel
2. EPS Insulation
3. Steel Joists 10"x12" - 16 Ga @ 24" OC
4. 1/2" NEXGEN ceiling
5. Optional wire chase @ 24" OC

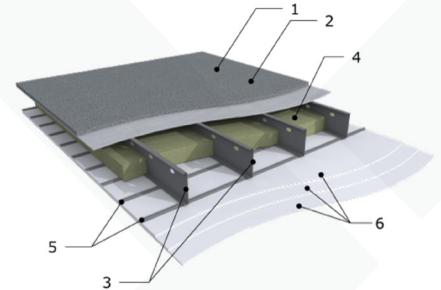

B-016 Assembly

1. Flooring material
2. 3/4" NEXGEN MgO Panel
3. Steel Joists 10" x 2" - 16 Gauge @ 24" OC
4. 140mm Fiberglass Insulation - Non-Combustible
5. 25 MSG Galv. Steel 1/2" Deep @ 12"OC
6. 1/2" NEXGEN MgO or 5/8" gypsum

Board Thickness Options - * in stock

Imperial:	Metric:
1/8" 1/4" 3/8"	3mm 6mm 10mm
1/2" * 5/8" 3/4"*	12mm* 15mm 18mm*

Board Dimension Options - all in stock

Imperial:	Metric:
4'x8' 4'x9'	1220x2440 1220x2750
4'x10' 4'x12'	1220x3050 1220x3660

Panel and Assembly Attributes

4'x8'x1/2" panel is 2.7 LBS/SF
 4'x8'x3/4" panel is 3.3 LB/SF
 All boards are square finished standard

Product Availability and Storage

MgO boards are stocked in North America for timely shipment | Store board horizontally | Do not stack above 12' | All pallets 4800 lbs max

Code Compliance - refer to NEXGEN Technical Data Sheet (TDS) on nexgenbp.com

National	Fire Ratings	Water Resistance	Strength	Mold Resistance
ICC-ES-ESR-2880	ASTM E135 ASTM E119 ASTM E136	ASTM C1186 ASTM E96	ASTM C1185-03 ASTM D2394	ASTM D3273
CCMC 14038_e	UL-263 ULC S102	ASTM C1185 Freeze/Thaw	ASTM C1325 Blast Rating Level 8	ASTM D5116 No Toxic VOC's



Scan the QR code to [go to the NEXGEN Resources web page](#) - insights, videos, technical and installation documents.

NEXGEN Building Products www.nexgenbp.com 1904 Manatee Ave #300 Bradenton, FL 34205 (855) 639-4361